

9799 DW Dual Straight/Boom Cymbal Stand

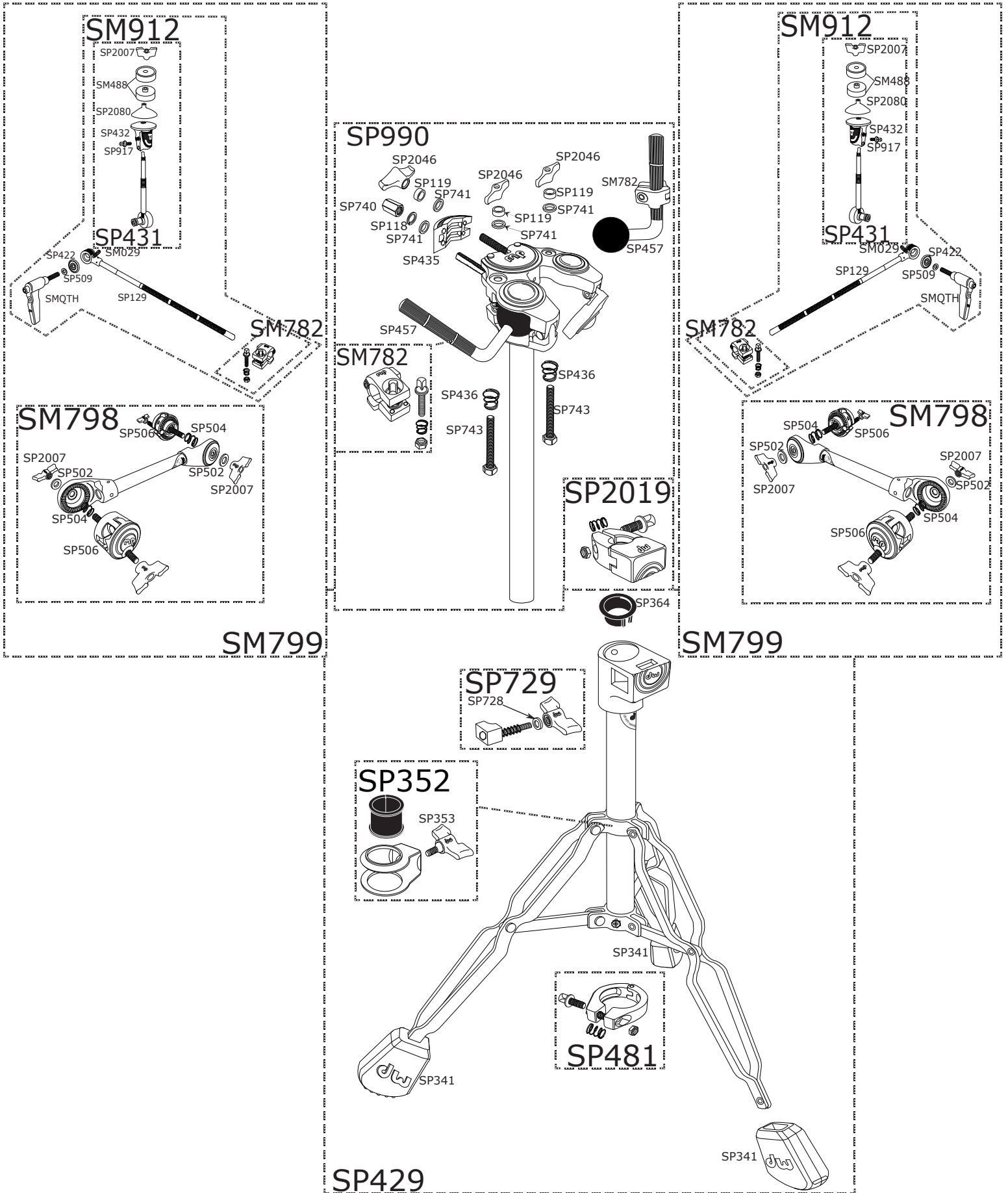

9799 DW Dual Straight/Boom Cymbal Stand

Part Number	Description
DWSMQTH	5/16 X 3/4 QUICK TURN HANDLE
DWSM029	3/8" DRUM KEY SCREW (4 PACK)
DWSP118	CLAMP NUT LOCKWASHER
DWSP119	WINGNUT SPACER
DWSP341	RUBBER FOOT
DWSP352	CLAMP FOR LEG ASSEMBLY
DWSP353	8MM WING SCREW
DWSP364	PLASTIC BUSHING
DWSP422	1-1/8" STEEL WASHER
DWSP429	TRIPOD ASSEMBLY TOM STAND
DWSP431	TILTER ASSEMBLY
DWSP432	CYMBAL SEAT
DWSP435	SWING BLOCK
DWSP436	SPRING
DWSP457	1/2" TOM L-ARM (BALL-IN-SOCKET)
DWSP481	1.25" MEMORY LOCK
DWSP488	PAIR OF TOP AND BOTTOM FELTS W/ WASHER
DWSP502	WASHER
DWSP504	3/4" RATCHET SPRING
DWSP506	3/4" RATCHET HOUSING
DWSP509	RATCHET BOLT WASHER
DWSP728	WASHER
DWSP729	CLAMP SCREW
DWSP740	HEX NUT
DWSP741	8MM WASHER
DWSP743	BOLT FOR BALL SOCKET
DWSM782	1/2" MEMORY LOCK
DWSM798	DOG BONE ACCESSORY ARM
DWSM799	STR/BOOM CYM ARM W/DBL CLAMP - CLAMSHELL
DWSM912	1/2 X 18 BOOM CYMBAL ARM
DWSP917	DRUM KEY SCREW
DWSP990	BALL IN SOCKET ASSEMBLY WITH 1" TUBE
DWSM934	BOOM ARM (DWSM912) 3/4" X 18" TUBE
DWSP2007	M8 WING NUT FOR TILTER (4 PACK)
DWSP2019	1" MEMORY LOCK
DWSP2046	WING NUT, 2005 STYLE
DWSP2080	BLACK PLASTIC CYMBAL SLEEVE

